

**Mounting:**

Your Ultradot is delivered with mounting rings that fit the diameter of your sight. These rings will attach to Weaver or Picatinny style scope rails / bases. The hex wrench for these rings is also included in the package.

- 1) Make sure that the scope base / rail is specified by the manufacturer of your gun and that it provides a uniform horizontal and vertical mounting platform. For your own safety, let a knowledgeable gunsmith inspect your weapon and mounting base to insure that everything is in safe order. Since there is no set eye relief for the Ultradot make sure that you have a minimum clearance of 3" between the sight and your eye.
- 2) Use the supplied Allen wrench to remove the cross bolt at the bottom of each ring, and to loosen the top Allen screw so that you can separate the two halves by approximately 3/8".
- 3) Slide one of the rings onto the base until it aligns with the cross cut groove on the scope base. Insert the cross bolt through the ring base and thread carefully. Loosely tighten so that it stays in place but can still be moved.
- 4) Insert your new Ultradot into the ring that you have just mounted and snug up the ring bolts a bit more. Make certain you have the potentiometer knob on the top of sight.
- 5) Slide the 2<sup>nd</sup> ring on the scope base and sight simultaneously. Insert the cross bolt through the mounting ring and cross cut groove on the scope base and loosely tighten.
- 6) Make sure the sight is mounted horizontally using a level whenever possible. When you are certain the sight is level, carefully tighten the mounting ring bolts making adjustments if necessary. Avoid tightening the rings directly over the sight's lenses as you can break the glass if you over-tighten. Also, it's a good idea to have the rear ring be in direct contact with the center housing of the sight body. This will help to prevent sliding during recoil.
- 7) After you have fired a few rounds, check the mounting screws again and re-tighten if necessary.

**Battery:**

The Ultradot is powered by a single 3 volt lithium battery (CR2032). When the red dot grows dim or darker, you will need to replace the battery with a new one. Simply unscrew the battery cover using a US nickel while holding the potentiometer in place. Remove the old battery. Place the new battery positive side up in the compartment and replace the cover.

**Polarizing Filter:**

Your Ultradot comes with a polarizing filter to help to control lighting on bright sunny days. The Matchdot II has the ability to attach the filter to either end of the sight, without removing the trim ring. The Ultradot 6 attaches the filter to the eyepiece side only. In either case, turning the front part of the filter clockwise you can adjust the brightness and contrast. Here's a tip: To help prevent the filter from turning on its own during shots, take the rubber eyepiece from the end of the sight and attach it to the polarizing filter by pushing it over the grip end. This will help to hold the polarizing filter in place.

**Zeroing:**

- 1) Activate your sight by turning the potentiometer in a clockwise motion to setting 1 (Always start with the lowest setting first and turn up until you have a clean dot) and remove the windage and elevation covers.
- 2) With the gun rested on a solid support, bore sight your weapon towards a small target 100 yards away. We suggest using a laser bore sighter to make this task easier and more accurate.
- 3) Sight through your Ultradot and use the windage adjustment screw and elevation knob to move the red dot to the same target. The Matchdot II's red dot will move 1 MOA per click at 100 yards and ½ MOA per click at 50 yards. The Ultradot 6 will move ½ MOA per click at 100 yards and ¼ MOA per click at 50 yards.
- 4) To avoid injury make sure that the sight is properly mounted before you fire your first shot. For handguns start to fire at 15 to 25 yards and for rifles, 25 to 50 yards. Shoot test groups of 3 rounds each and adjust between each group. Always use the same type of ammunition while zeroing your gun.
- 5) To move the point of impact up, turn the elevation adjustment knob in the direction of the up arrow and for down turn the opposite. To move the point of impact to the left turn the windage adjustment screw in the direction of the "L" arrow. To move right turn the opposite direction.
- 6) Once you have zeroed your gun move to the distance you will be shooting most often and make final adjustments.
- 7) Replace the windage cover.
- 8) You're Done!

**Reticle Selection:**

The Ultradot 6 and the Matchdot II both have 6 different reticles to choose from. The four red dot sizes are 2,4,6 and 8 MOA and the two reticle patterns have center dot sizes of 2 and 8 MOA. To change the reticle, simply rotate the reticle selector knob until you reach a dot or pattern you are happy with. The point of impact will not change when you change the reticle.

## Specifications:

### ***Ultradot 6***

LENGTH: 149mm

WIDTH: 54mm

HEIGHT: 42mm

WEIGHT: 5.9 oz. (137 g)

DOT SIZE: 2,4,6,8 MOA and 2 reticle patterns with 2 and 4 MOA centered dots.

BATTERY TYPE: Lithium, 3V, Duracell DL 2032

BATTERY LIFE: 200 – 4,000 hours, can be stored for 5 yrs.

MIRROR LENS: Specially coated for specific wavelength band

FILTER SYTEM: Dual, inter-adjustable, Polaroid Filters for max. Versatility during extreme light conditions

POTENTIOMETER: Eleven clearly marked and easily distinguishable click stops.

ELEVATION and WINDAGE: 1/2 MOA per click @ 100 yards and 1/4 MOA @ 50 yards.

DOT ELECTRONICS: Illumination

MOUNTING: Comes with Weaver-style rings

PACKAGE INCLUDES: Red-Dot Sight, battery, polarizing filter, mounting rings and hex wrench.

### ***Matchdot II***

LENGTH: 137mm

WIDTH: 54mm)

HEIGHT: 42mm)

WEIGHT: 5.1 oz.

DOT SIZE: 2,4,6,8 MOA and 2 reticle patterns with 2 and 4 MOA centered dots.

BATTERY TYPE: Lithium, 3V, Duracell DL 2032

BATTERY LIFE: 200 – 4,000 hours, can be stored for 5 yrs.

MIRROR LENS: Specially coated for specific wavelength band

FILTER SYTEM: Dual, inter-adjustable, Polaroid Filters for max. Versatility during extreme light conditions

POTENTIOMETER: Twelve clearly marked and easily distinguishable click stops.

ELEVATION and WINDAGE: Adjustments of 1 MOA increments per click @ 100 yards and ½ MOA @ 50 yards.

DOT ELECTRONICS: Illumination

MOUNTING: Comes with Weaver-style rings

PACKAGE INCLUDES: Red-Dot Sight, battery, polarizing filter, tube extension, mounting rings and hex wrench.

Congratulations on your purchase of a new Ultradot product! The Ultradot 6 Series features the same quality construction, precision accuracy and value for the dollar that have made Ultradot what it is today. A leader in the design and manufacture of Advanced Red Dot Aiming Systems.



**WWW.ULTRADOTUSA.COM**

**ULTRADOT DISTRIBUTION, 6304 RIVERSIDE DRIVE, YANKEETOWN, FL 34498 USA**

# Ultradot 6 SERIES

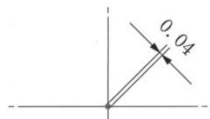

A Pattern (2M. O. A)

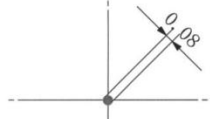

B Pattern (4M. O. A)

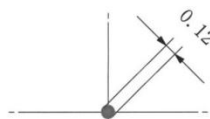

C Pattern (6M. O. A)



D Pattern (8M. O. A)

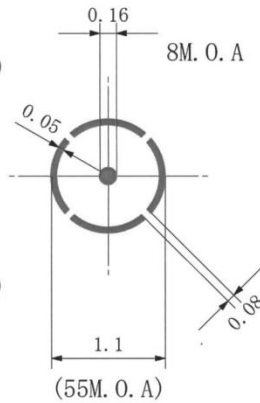

E Pattern

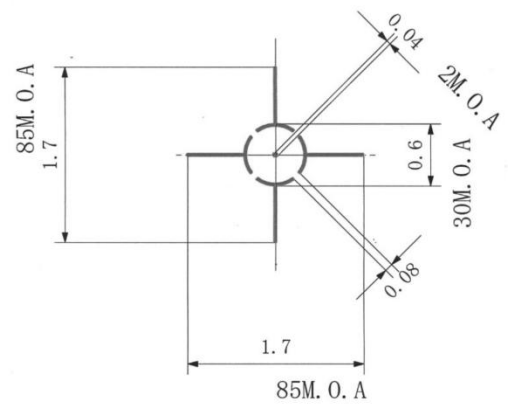

F Pattern

